

Installation Instruction

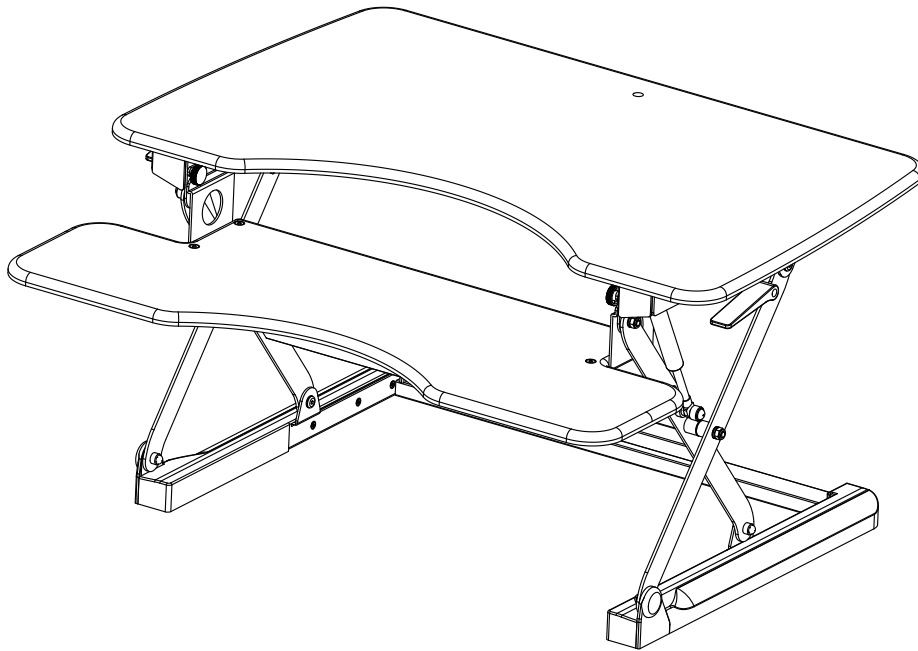

UNPACKING INSTRUCTIONS

- Carefully open the carton, remove contents and lay out on cardboard or other protective surface to avoid damage.
- Check package contents against the Supplied Parts List in the next page to assure that all components were received undamaged. Do not use damaged or defective parts.
- Carefully read all instructions before attempting installation.

IMPORTANT SAFETY INFORMATION

Install and operate this device with care. Please read this instruction before beginning the installation, and carefully follow all instructions contained herein. Use proper safety equipment during installation.

Please call a qualified installation contractor for help if you:

- If you don't understand these directions or have any doubts about the safety of the installation.
- If you are uncertain about the nature of your wall, consult a qualified installation contractor.

Do not use this product for any purpose or in any configuration not explicitly specified in this instruction. We hereby disclaim any and all liability for injury or damage arising from incorrect assembly, incorrect mounting, or incorrect use of this product.

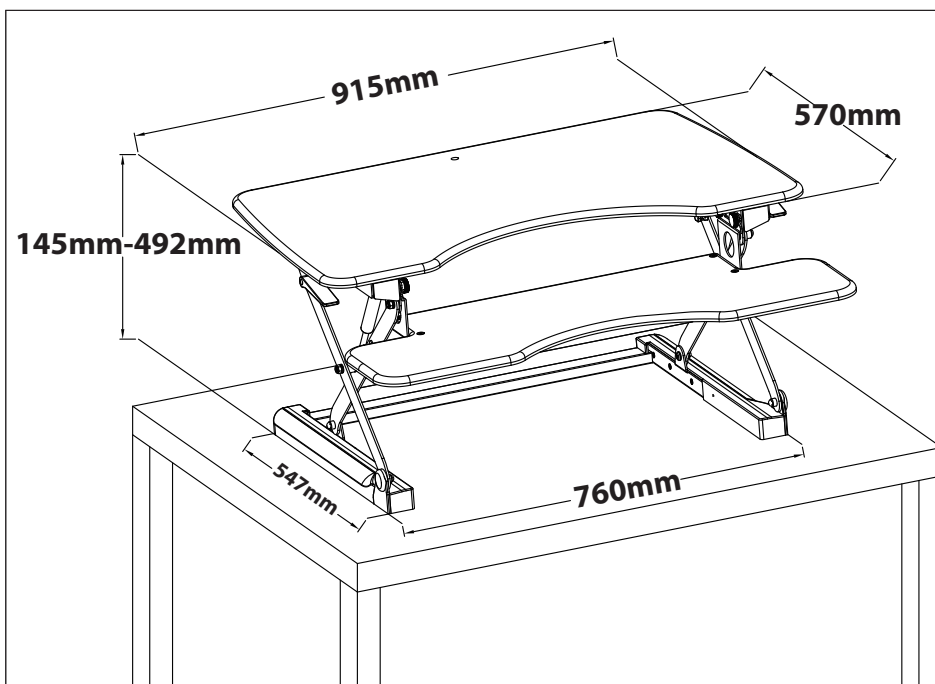
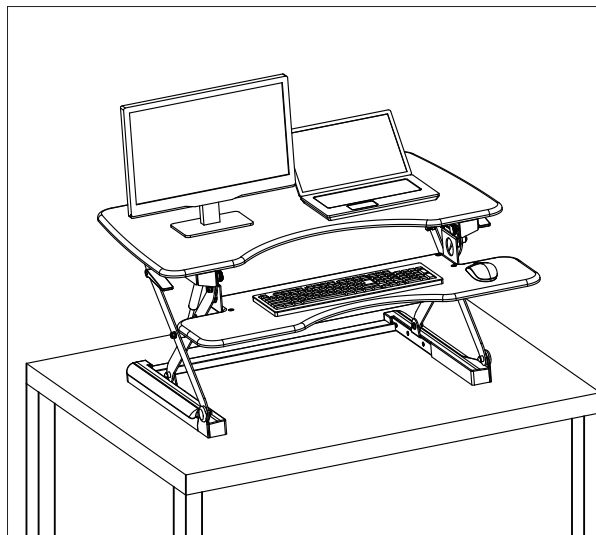
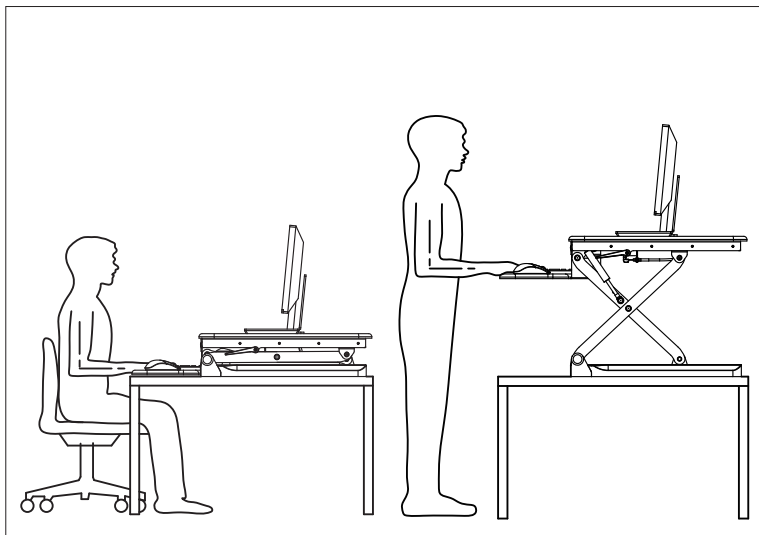

15.9kg/35 lbs



WARNING
Do not exceed
the maximum
weight

Supplied Parts List

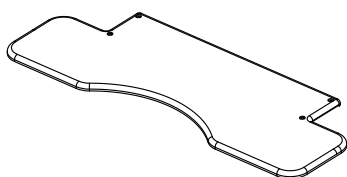

(1) Keyboard Tray-a

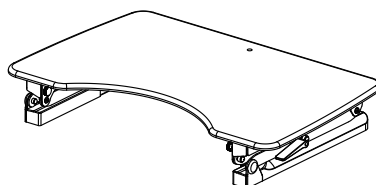

(1) Standing Desk-b



(4) M6x12 Bolt-c

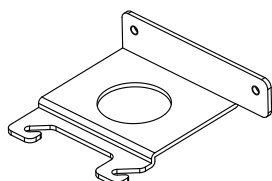

(1) Tray Connecting
Bracket (Left) -d1

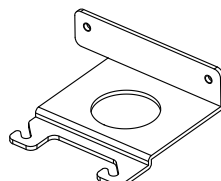

(1) Tray Connecting
Bracket (Right) -d2



(1) Allen Key-e

Setp 1

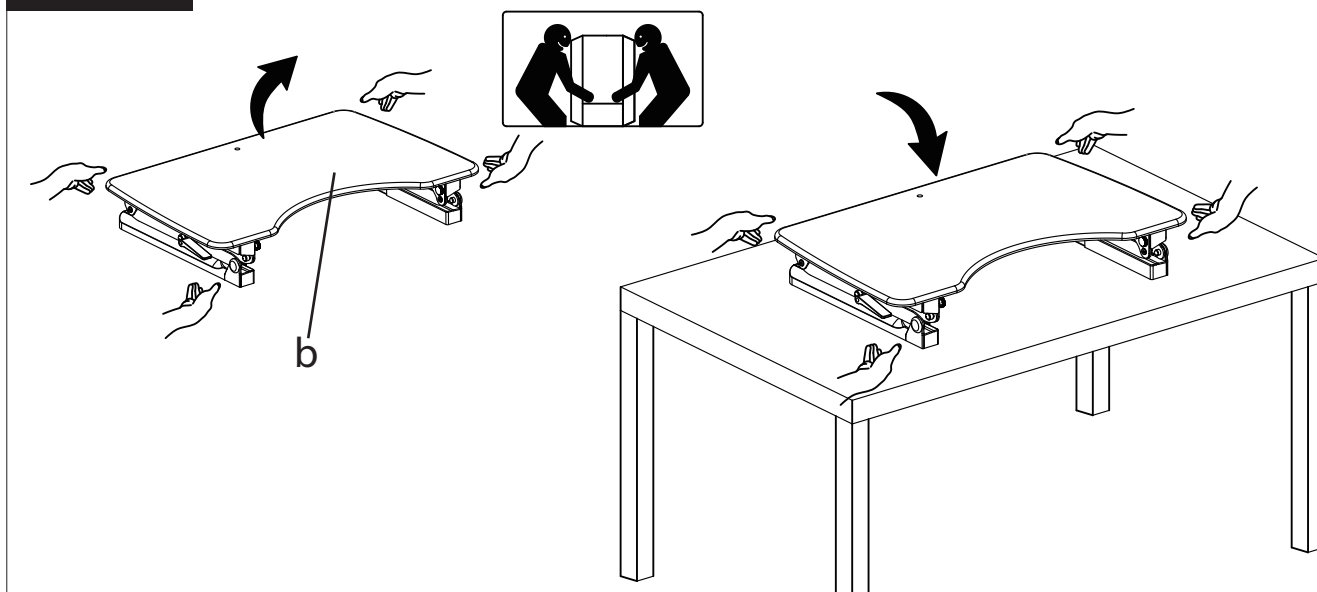

Setp 2

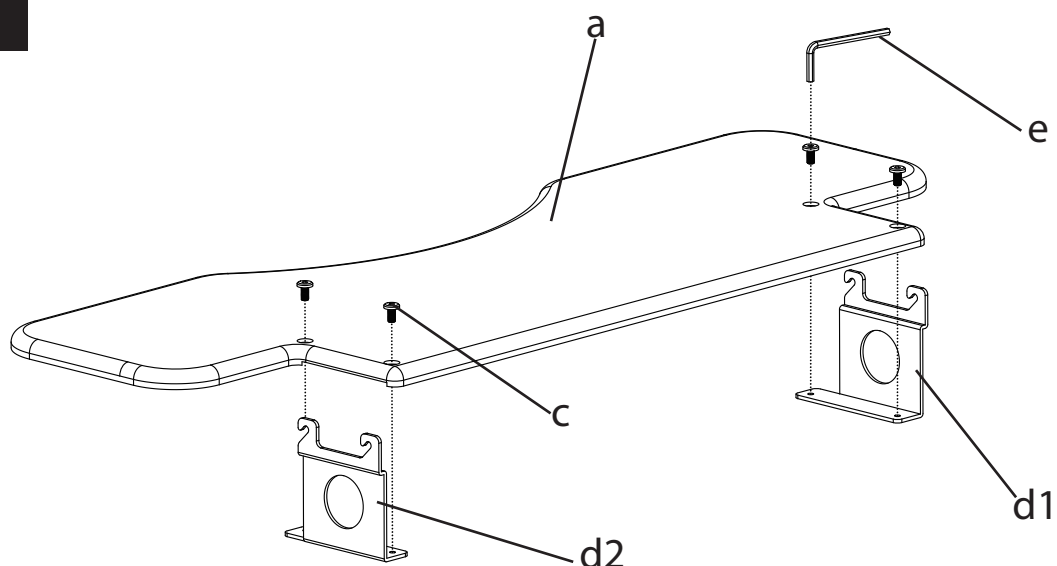

Setp 3

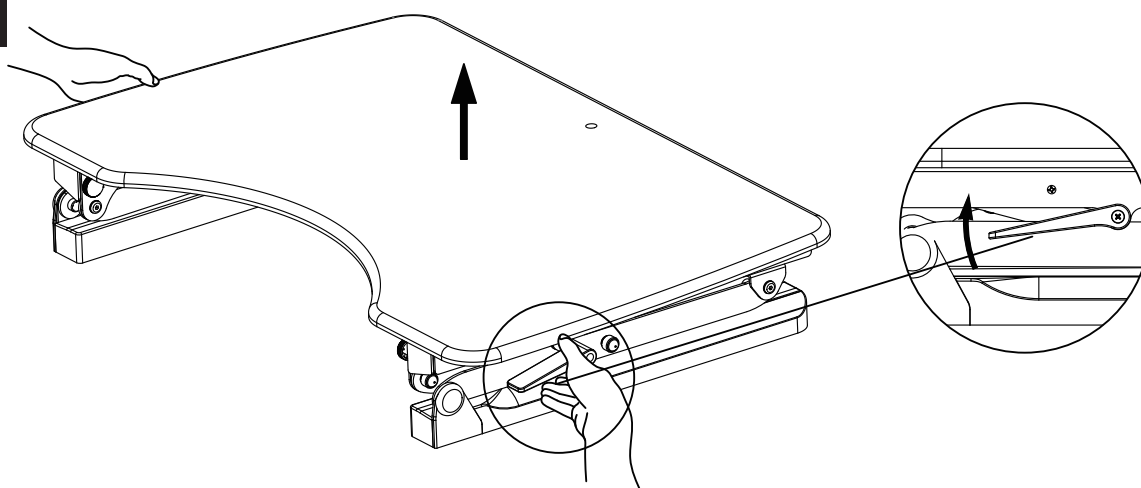

Setp 4

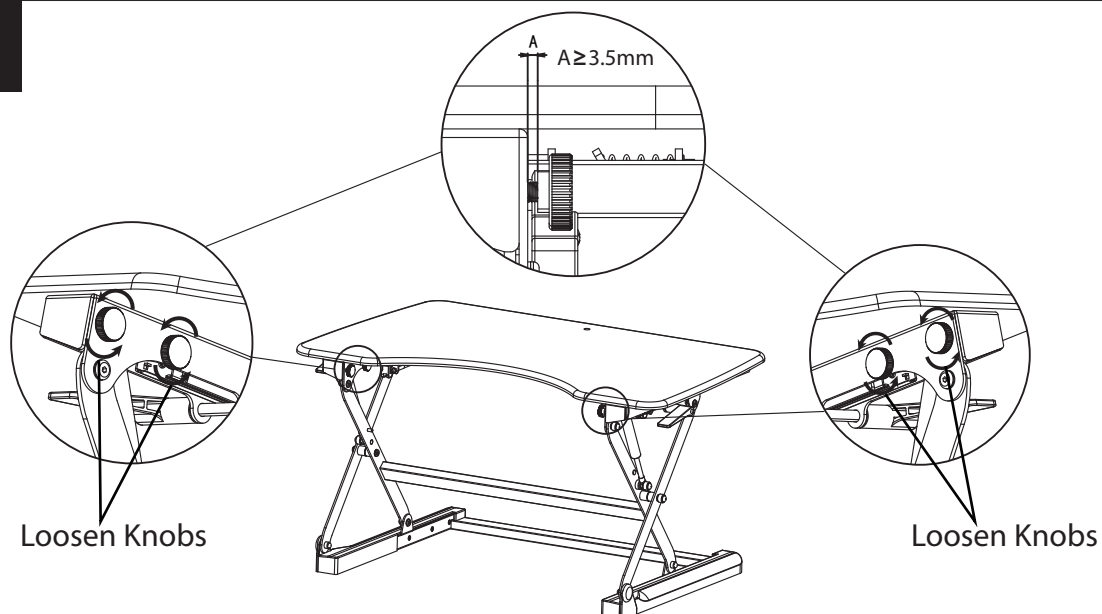

Setp 5

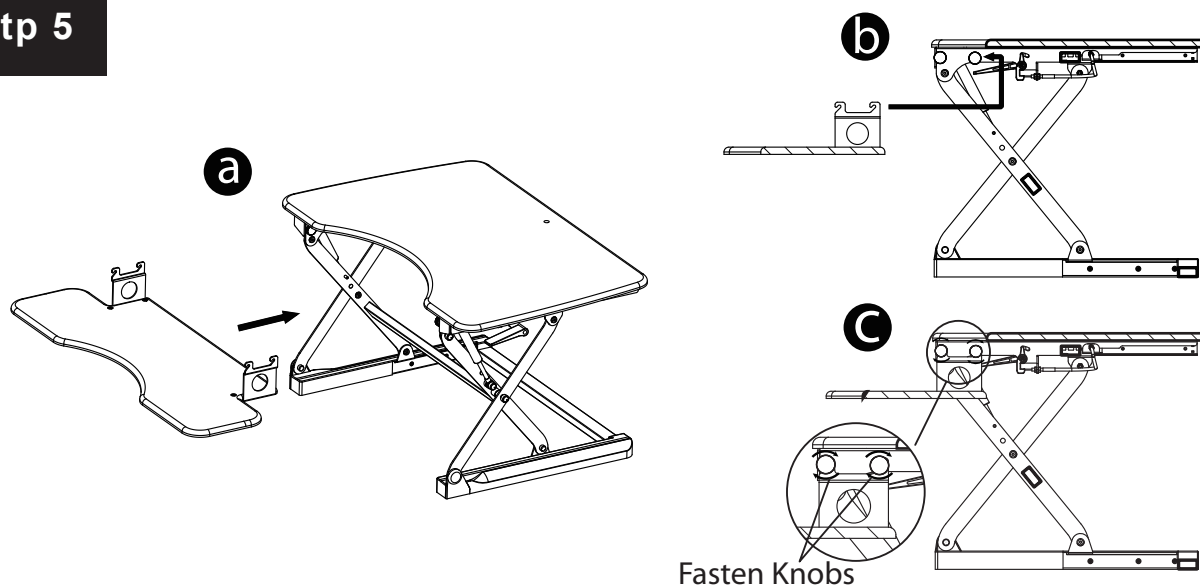

Setp 6

